

## 1-PIECE FULL PORT WAFER TYPE BALL VALVES

**FIG. S-138W / C-138W: WAFER TYPE, PN16 FLANGED ENDS, ISO 5211 MOUNTING PAD.**

**FEATURES:**

- Uni-body design with wafer type flanged ends for fast installation, in-line maintenance and rebuilding. Solid ball construction provides structural integrity and minimizes flow turbulence.
- Body joint is designed to prevent excessive compression of valve internals, resulting in a consistent and low operating torque.
- Mounting pad complied with ISO 5211 for ease and interchangeability of actuation.
- Bottom-loaded blow-out proof stem. Adjustable packing gland.
- Basic design complied with ANSI B 16.34, DIN 3339, DIN 3357-2, & EN 12516-1.
- Flange mating dimensions complied with DIN 2501-1 & DIN 2543 PN 16.
- Tested according to DIN 3230-3 (strength & leakage test) & API 598.



**MATERIALS LIST:**

NO.	PARTS	S-138W	C-138W
1	BODY	ASTMA351-CF8M / DIN 1.4408	ASTMA216-WCB / DIN 1.0619
2	RETAINER	ASTMA351-CF8M / DIN 1.4408	ASTMA216-WCB / DIN 1.0619
3	SEAT	PTFE	PTFE
4	BALL	ASTMA351-CF8M / DIN 1.4408	ASTMA351-CF8 / DIN 1.4308
5	GASKET	PTFE	PTFE
6	STEM	ASTMA276-316 / DIN 1.4401	ASTMA276-304 / DIN 1.4301
7	THRUST WASHER	PTFE	PTFE
8	STEM PACKING	PTFE	PTFE
9	GLAND	AISI 304 / DIN 1.4301	AISI 304 / DIN 1.4301
10	PACKING NUT	AISI 304 / DIN 1.4301	AISI 304 / DIN 1.4301
11	HANDLE WASHER	AISI 304 / DIN 1.4301	AISI 304 / DIN 1.4301
12	HANDLE NUT	AISI 304 / DIN 1.4301	AISI 304 / DIN 1.4301
13	HANDLE	AISI 304	ZINC PLATED STEEL
14	HANDLE COVER	PVC	PVC
15	STOP SCREW	AISI 304 / DIN 1.4301	CARBON STEEL

**OPTIONS:**

-A: ANTI-STATIC DEVICE. -M: TAPPED MOUNTING PAD. -V: VENTED BALL.

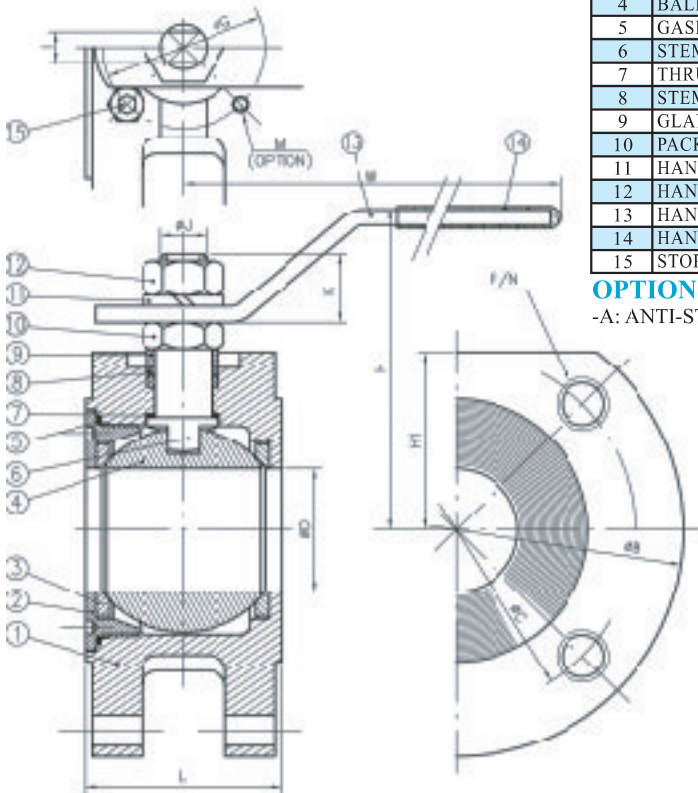

**DIMENSIONS**

SIZE		φD		L		I		φJ		K		φG		M	φC		φB		P	N	H		W	
in	mm	in	mm	in	mm	in	mm	in	mm	in	mm	in	mm	mm	in	mm	in	mm	mm		in	mm	in	mm
1/2"	15	0.59	15	1.57	40	0.26	6.5	0.39	10	0.41	10.5	1.42	36	M5	2.56	65	3.74	95	M12	4	2.48	63	4.92	125
3/4"	20	0.79	20	1.73	44	0.26	6.5	0.39	10	0.41	10.5	1.42	36	M5	2.95	75	4.13	105	M12	4	2.68	68	4.92	125
1"	25	1.00	25.4	2.09	53	0.31	8.00	0.55	14	0.65	16.5	1.65	42	M6	3.35	85	4.53	115	M12	4	3.19	81	6.30	160
1 1/4"	32	1.26	32	2.28	58	0.31	8.00	0.55	14	0.65	16.5	1.65	42	M6	3.94	100	5.31	135	M16	4	3.43	87	6.30	160
1 1/2"	40	1.50	38	2.36	60	0.31	8.00	0.55	14	0.65	16.5	1.97	50	M6	4.33	110	5.31	140	M16	4	3.70	94	7.87	200
2"	50	1.97	50	2.83	72	0.39	10.00	0.63	16	0.83	21	1.97	50	M6	4.92	125	6.10	155	M16	4	4.13	105	7.87	200
2 1/2"	65	2.56	65	3.70	94	0.47	12.00	0.79	20	1.02	26	2.76	70	M8	5.71	145	7.28	185	M16	8	4.76	121	9.84	250
3"	80	2.99	76	4.65	118	0.47	12.00	0.79	20	1.02	26	2.76	70	M8	6.30	160	7.87	200	M16	8	6.02	153	11.22	285
4"	100	3.78	96	5.51	140	0.47	12.00	0.79	20	1.02	26	2.76	70	M8	7.09	180	8.66	220	M16	8	6.46	164	13.31	338

